

# Access Map

Doshisha University Muromachi Campus (Kyoto, Japan)

Registration: Kambaikan (寒梅館) (B1F)

103 Goshō Yahata-cho, Kamidachiuri-sagaru,

Karasuma-dori, Kamigyo-ku, Kyoto-shi

TEL: +81-(0)75-251-0880

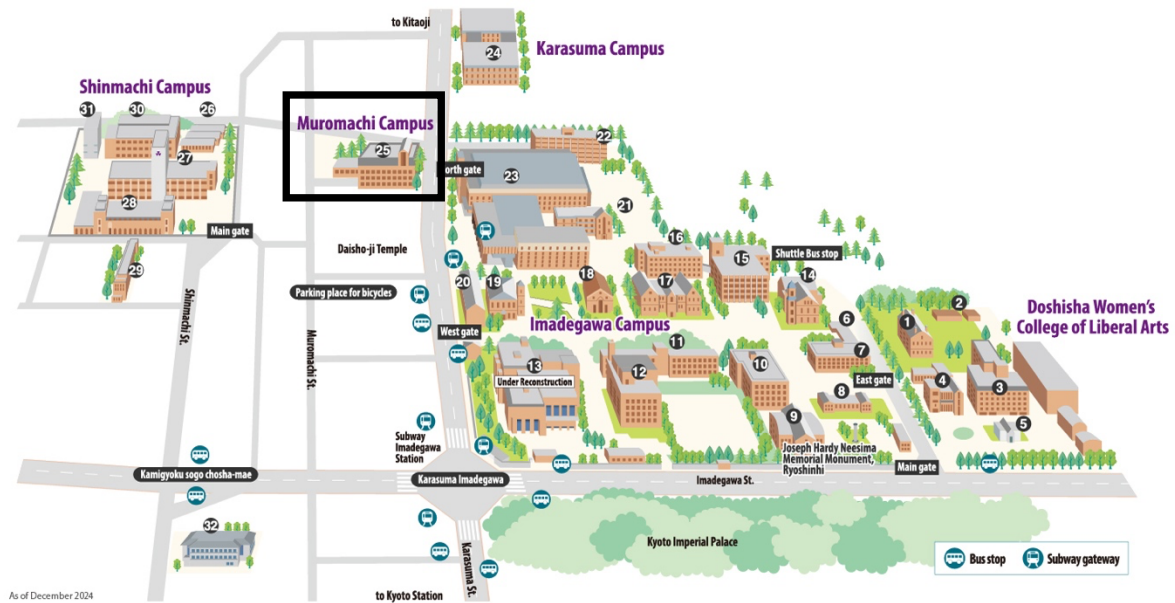

Kambaikan (寒梅館)

Exterior view



Hardy Hall (B1F)



Please take the **Subway “Karasuma Line”** and go to **Imadegawa Station (K 06)**. Take the North Exit No.2. Kanbaikan is located in a two-minute walk.

## Floor Map

Lectures and oral presentation	: B1F Hardy Hall, Room A
Luggage (staff) room	: B1F (Colver Hall)
Lunch-on seminar	: Room A
Poster presentation	: Gallery Hall

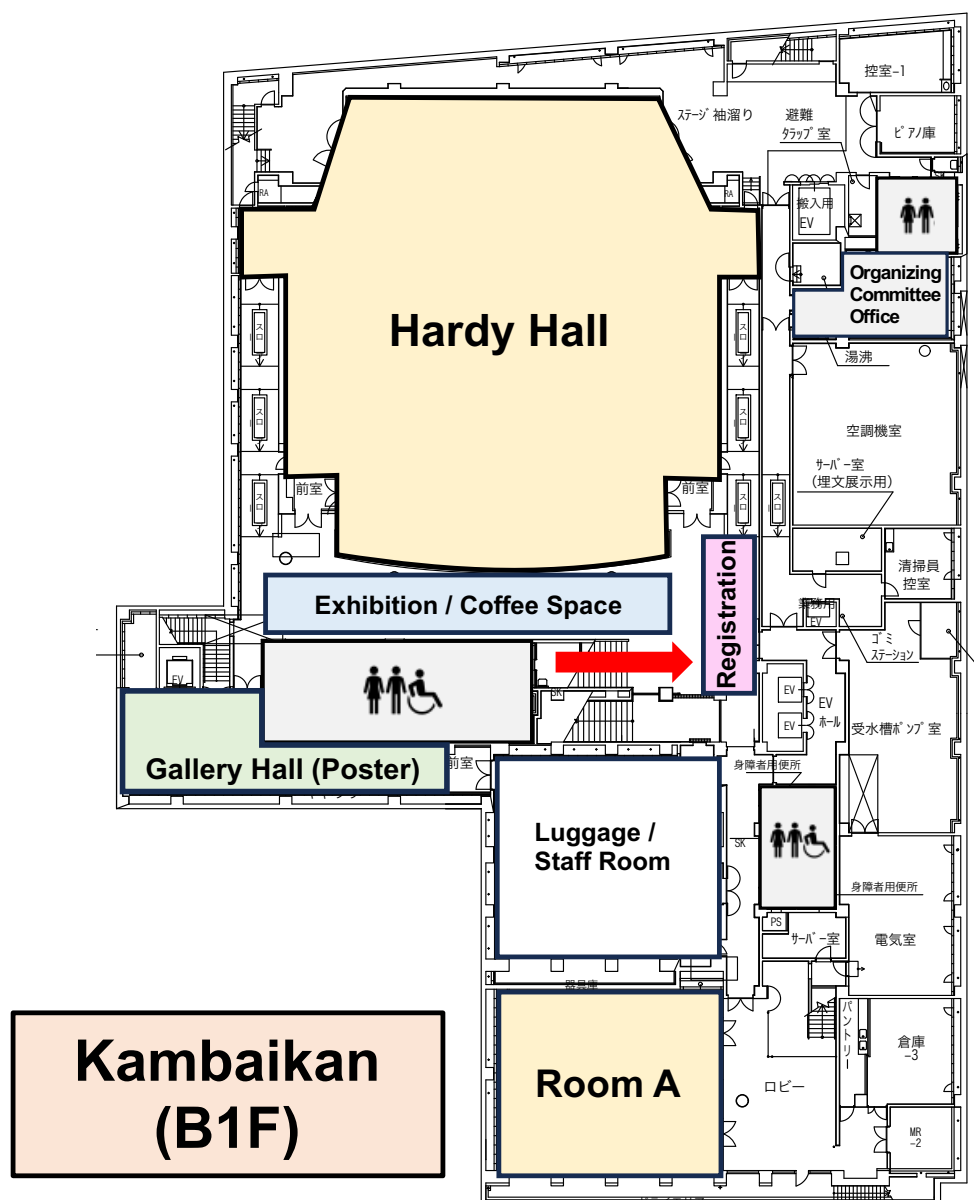

## **General Information**

### **【Registration】**

From 8:40 on Friday 7<sup>th</sup> November at Kambaikan (B1F), Doshisha University Muromachi Campus. On-Site Registration: Payment will be accepted in cash or credit card (VISA, MasterCard, JCB, and American Express).

### **【Access】**

Public transportation is recommended. No parking is available in the campus.

### **【Luggage / Staff room】**

Luggage storage is available. Luggage / Staff room (B1F, Clover Hall) will be open from 8:40 on Fri, 7<sup>th</sup> to 17:00 on Sun, 9<sup>th</sup> November. The Luggage room will be closed after the end of the schedule for the day. Please note that the Organizing Committee cannot be held responsible for any loss or damage. Please ensure that your personal belongings are kept with you at all times.

### **【Prohibition】**

No food and drink (Bottled drinks are OK) are allowed in Hardy Hall (main hall) and Luggage / Staff room. Lunch box could be taken in front of Room A. Smoking is prohibited anywhere on the Doshisha University campus.

### **【Chairperson】**

Please be seated at the designated seat at least 10 minutes before the session. Please control the progress and time arrangement of the session. Introduction of the Keynote, Invited, and Oral speakers by the chairpersons should be limited by reading the title and the name of presenters, meaning that the introduction including CV should be only for Plenary lectures.

### **【Oral Presentations】**

#### **1. Time**

Plenary Lecture: 50 min (Presentation 40 min + Discussion 10 min)

Keynote Lecture: 30 min (Presentation 25 min + Discussion 5 min)

Invited Lecture: 20 min (Presentation 15 min + Discussion 5 min)

Award Lecture1 (Japanese Session): 40 min

Award Lecture2 (Japanese Session): 20 min

Oral Presentation: 15 min (Presentation 12 min + Discussion 3 min)

Flash Presentation: 3 min

Lunch-on Seminar: 60 min (Presentation ~40 min + Discussion ~20 min)

## 2. Additional

- Please complete the following preparations at least 5 minutes before the session begins: Confirm the operation of the podium and equipment; Ensure slides (recommended format: PowerPoint or PDF, 16:9) load correctly and display without issues.
- Speakers (PL, KL, IL, OL) can bring and use their own PC for presentations.  
**HDMI connection should be fine for all presenters.** Please ask to registration desk if the speakers need to use another connection type.
- We recommend **all the Flash Presenters bring your PPT slides on a USB flash drive and use the laptop** provided at the conference table for your presentation.  
**We will receive your PPT data for Flash Presentations at the registration desk.**
- All presenters are required to strictly adhere to the designated presentation time limit to ensure the session proceeds in a timely and orderly manner.

### 【Lunch-on Seminars】

The Lunch-on Seminar will be held in Room A on Friday and Monday from 12:20 PM to 1:30 PM. Lunch boxes will be provided all the conference days.

### 【Selection of Poster Awards】

Please obtain the scoring sheets at the registration desk before the poster session. The scoring sheets should be submitted to the registration desk as soon as possible after the poster session.

### 【Poster Session】

1. Size: A0 or the similar size
2. Display and Retrieval: Push-pins are available at the venue. Posters may be displayed on the day of the poster session; however, all materials must be removed promptly upon conclusion of the session.
3. Poster Award: Award-winner will be announced during Closing Ceremony (14:50 – 15:20) on Monday, 10th November. The applicants of poster awards should attend Closing Ceremony.

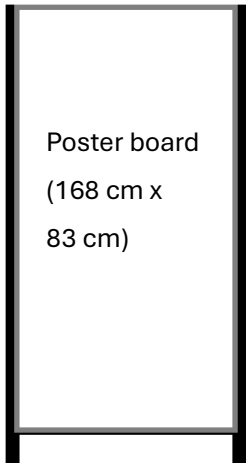

Poster board  
(168 cm x  
83 cm)

### 【Wi-Fi connection】

Free Wi-Fi will be available at Hardy Hall and conference venue. ID and password will be informed at the registration desk. **Eduroam** will also be available. Please allow that the network becomes sometimes unstable and may occasionally slow down.

## [Welcome Reception & Excursion & Banquet]

### Welcome Reception:

Held in the evening from **18:30 to 21:00** on 7th November, 2025 at Instyle Wedding at Shijo-Station. **All participants are welcome to attend.**



Instyle Wedding

Please take the **Subway “Karasuma Line”** and go from **Imadegawa (K 06)** to **Shijo Station (K 09)**. Please use **South Exit 6**. Instyle Wedding is located in a 30 sec walk from the exit.

**Excursion:**

Held in the afternoon from 12:45 to 18:00 on 8th November, 2025.

Bus tour to Toei Kyoto Studio Park and Japanese Tea Experience at Myoshinji Taizoin.



## ***Half-day Tour in Kyoto***

(November 8 after lunch)



### **Itinerary**

**12:45**            **Depart Venue (by chartered bus)**

**13:20-15:00**   **Toei Kyoto Studio Park**

**13:30~**   **Ninja Show**

**14:30~**   **Yokai Parade**

**15:15-17:00**   **Myoshin-ji Temple**

**Visit Main Hall & Japanese Tea Experience**

**18:00**            **Kyoto Station Hachijo-guchi**

*\*The itinerary is subject to change without notice.*





## Banquet:

Held in the evening from 18:30 to 21:30 on 9 November, 2025 at Hotel Granvia Kyoto (3F Genji Ballroom).

Participation fee: 10,000 JPY

Participation fee for Accompanying Person: 10,000 JPY

Participation fee for Accompanying Person (Child 6-18): 5,000 JPY

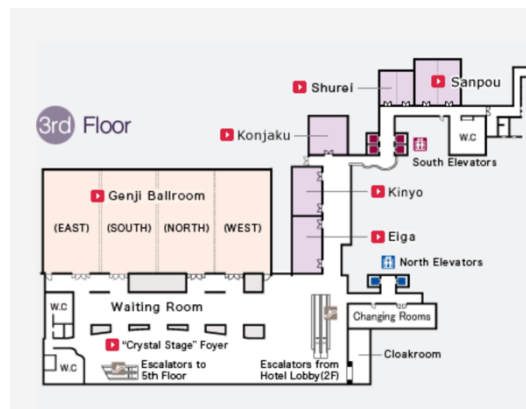
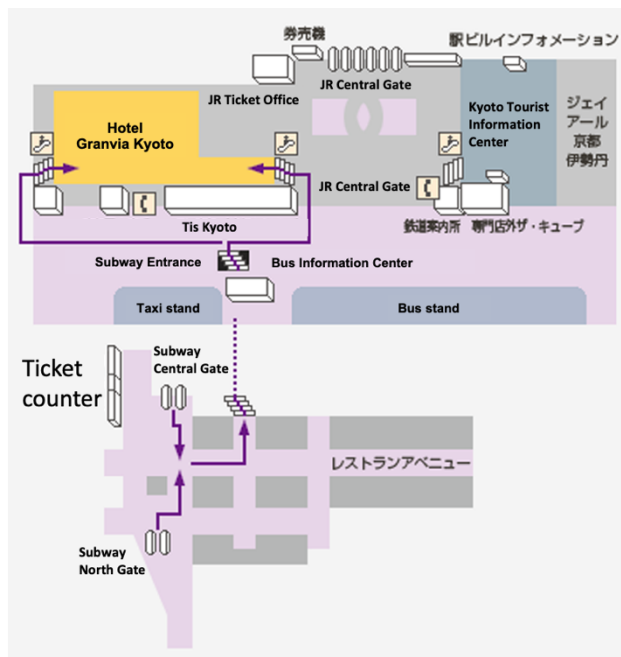

(Genji Ballroom)

## For Students in The Society of Cyclodextrin, Japan 【学生支援奨学金をご希望の方】

学生支援奨学金の受け取りを希望する方は、学生証をご持参の上、日本シクロデキストリン学会事務局（Registration desk の近く）まで、会期中にお越しください。なお、対象者は本シンポジウムで発表を行った日本シクロデキストリン学会の学生会員に限ります。